

AOS Galileo™ Lag Screw Removal Tool

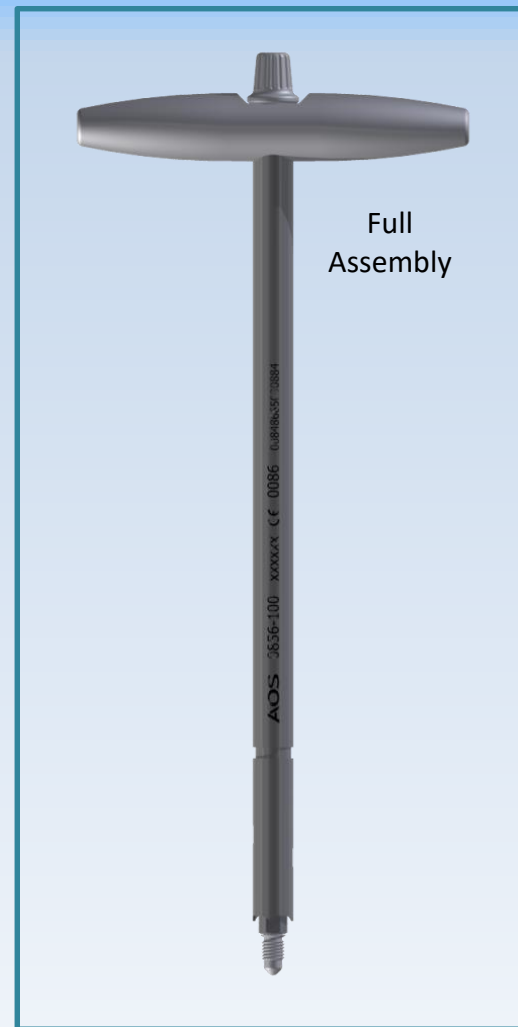

TECHNIQUE GUIDE

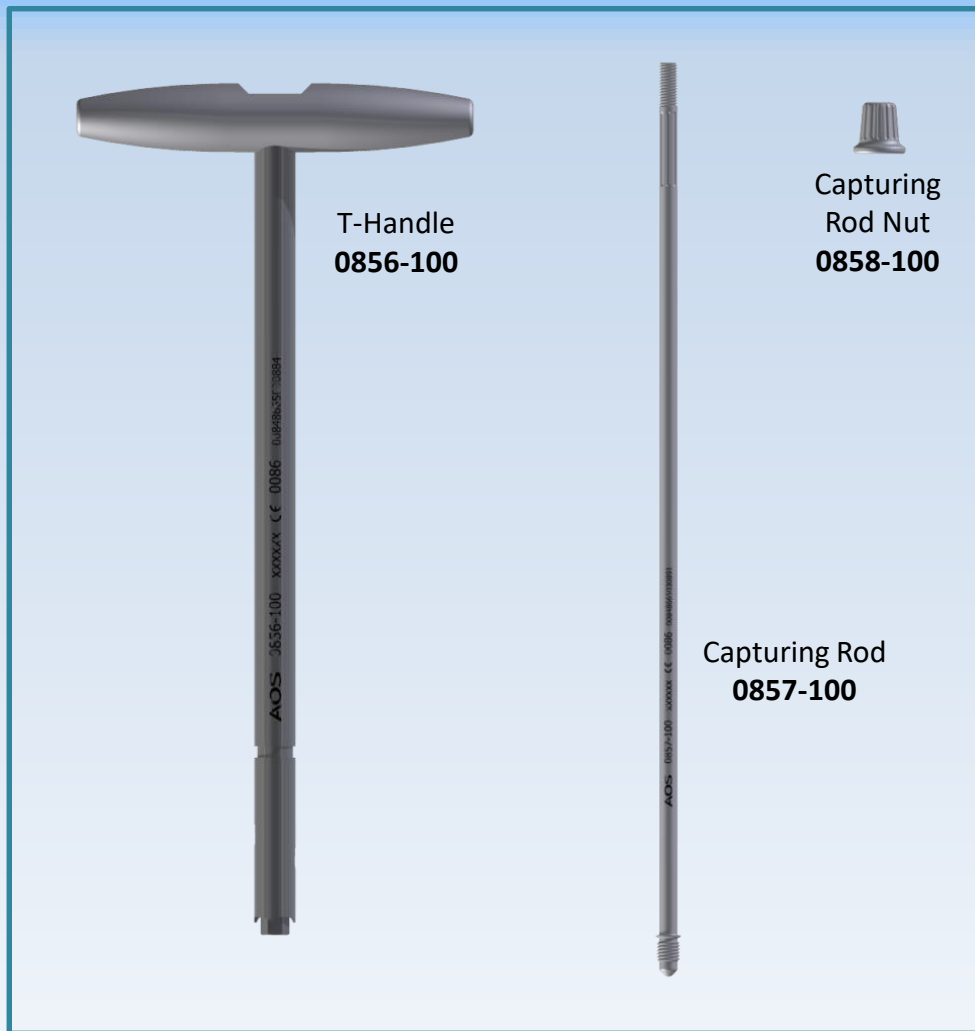

STEP 1

CLEAR OUT ALL BONEY INGROWTH FROM LATERAL ASPECT OF GALILEO LAG SCREW, INCLUDING AROUND LATERAL “CROWN”, TO ENSURE THE REMOVAL TOOL ENGAGES AND UNLOCKS THE SCREW PROPERLY

STEP 2

SCREW CAPTURING ROD INTO
LAG SCREW FINGER TIGHT

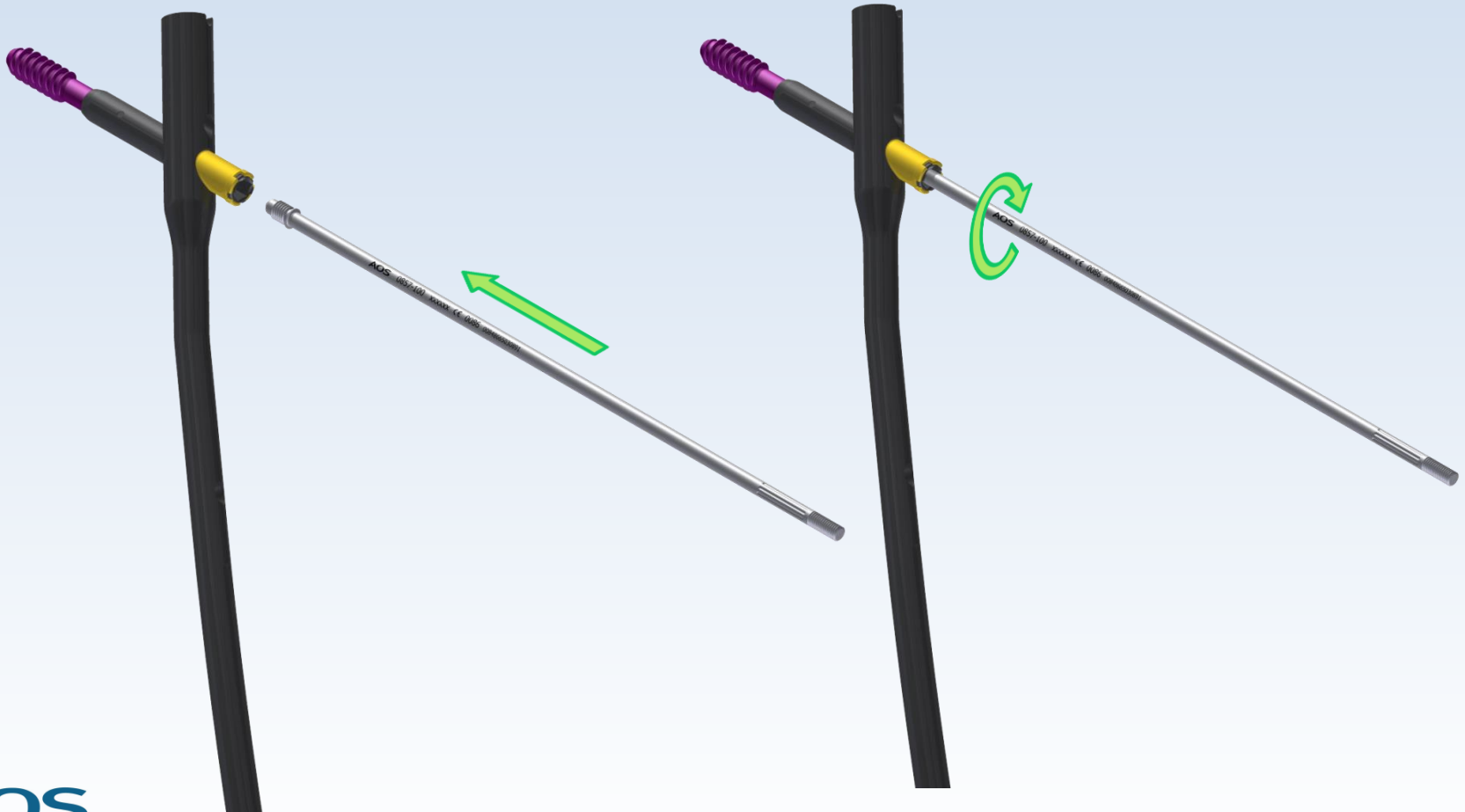

STEP 3

INSERT T-HANDLE OVER CAPTURING ROD
AND DOWN TO LAG SCREW, THEN ROTATE
WITH FORWARD PRESSURE UNTIL HEX
ENGAGES IN LAG SCREW

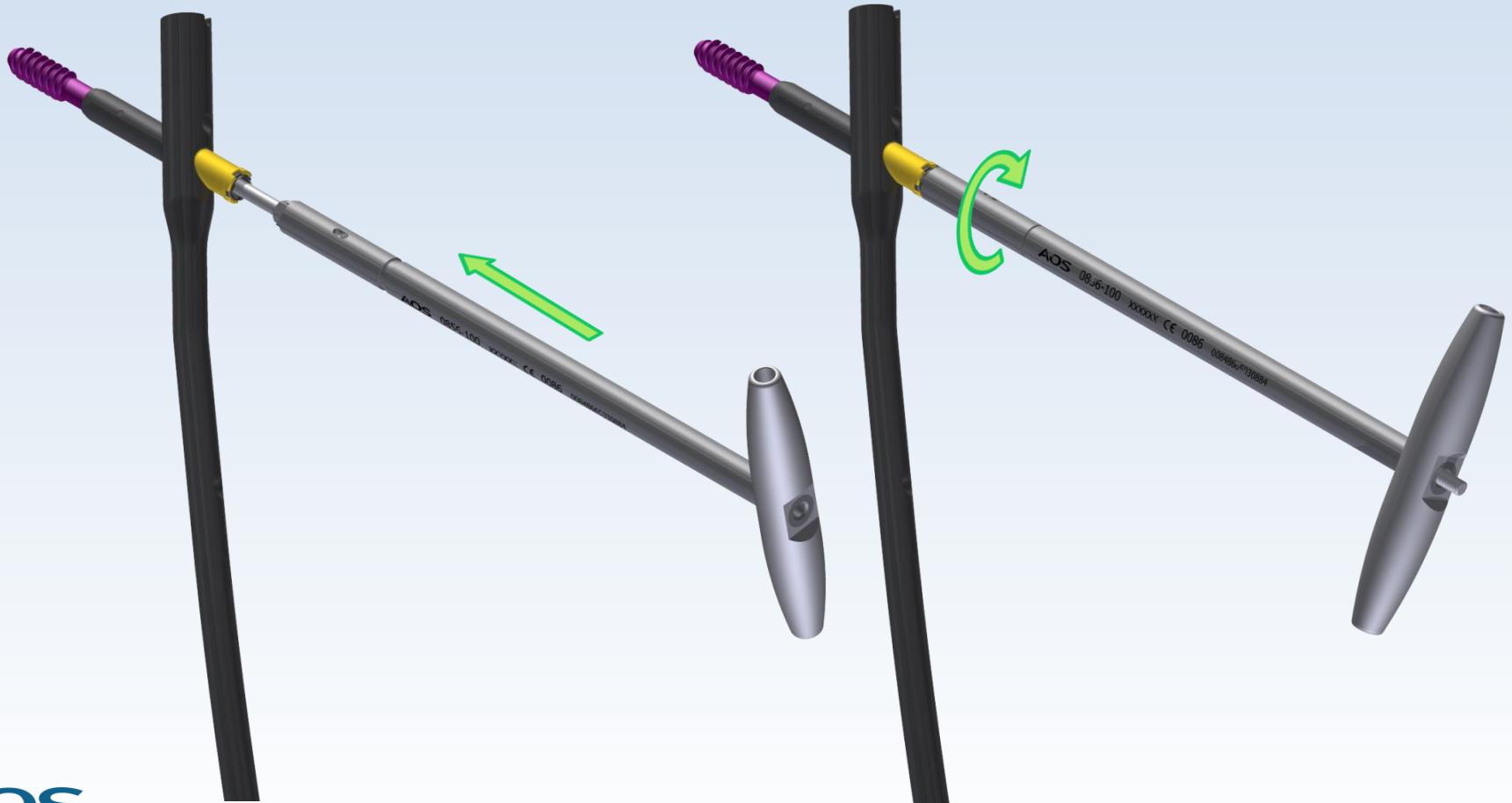

STEP 4

SCREW CAPTURING NUT ONTO BACK END
OF CAPTURING ROD TO SECURE
INSTRUMENT TO LAG SCREW

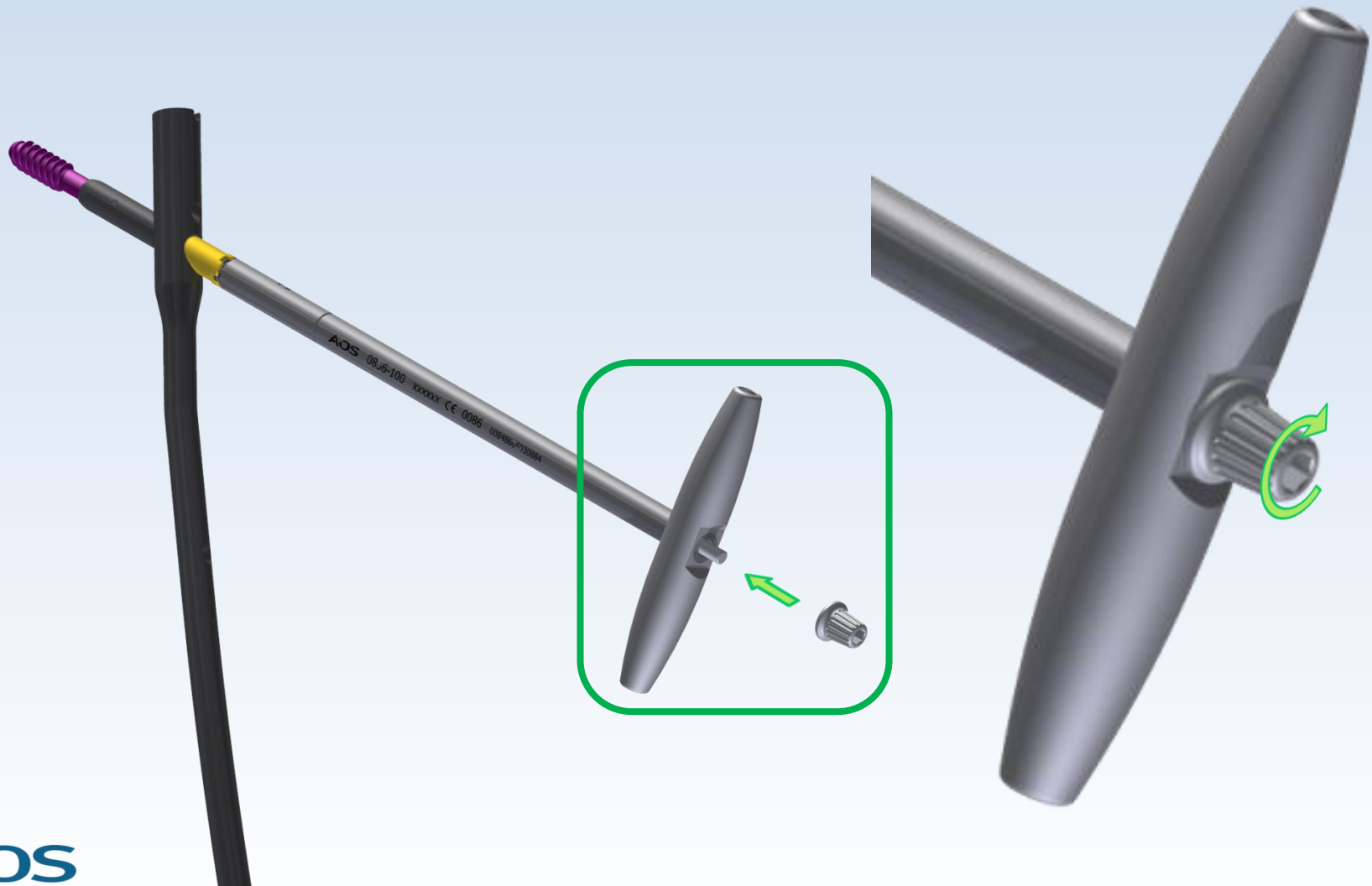

STEP 5

ROTATE T-HANDLE **CW** FOR $\approx \frac{1}{2}$ TURN, THEN BACK SCREW OUT BY ROTATING **CCW** AND PULLING LATERALLY UNTIL FULLY REMOVED.

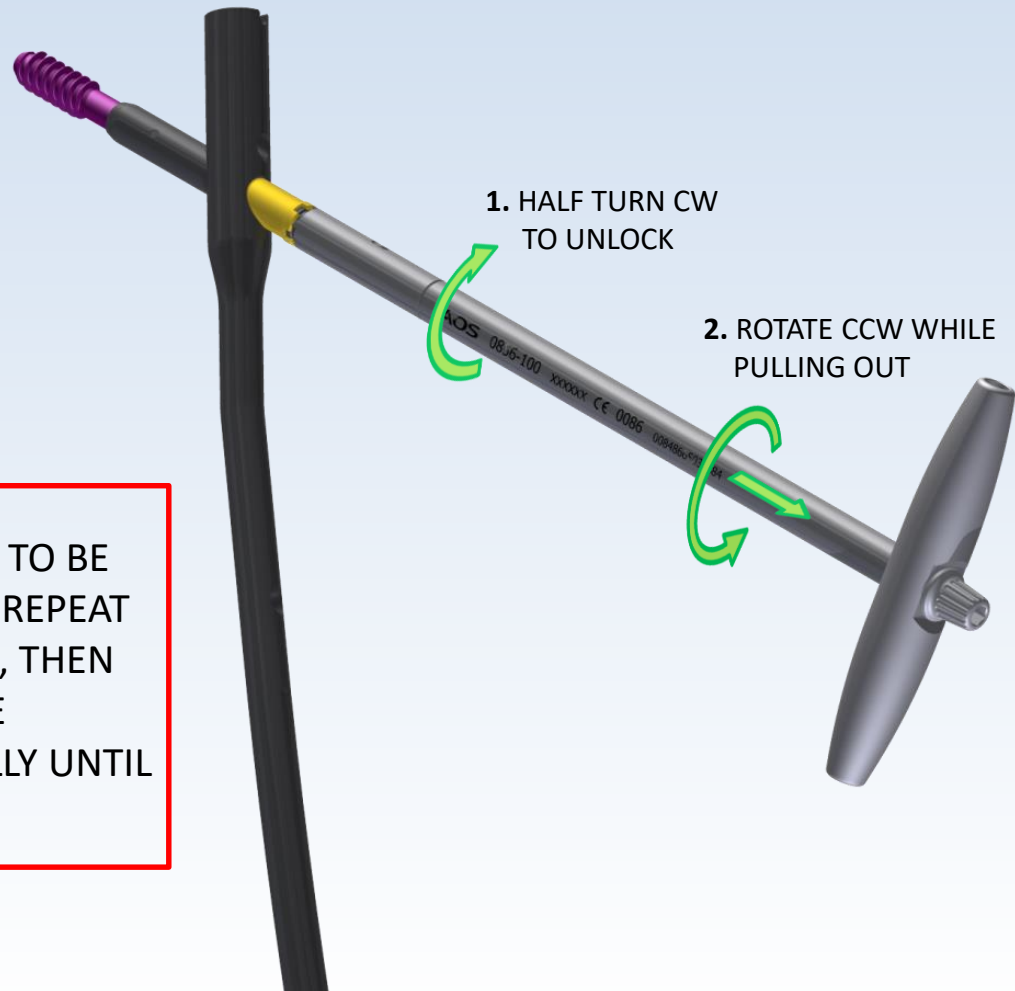

*** TIP**

IF LAG SCREW STILL SEEMS TO BE LOCKED TOO TIGHTLY TO REMOVE, REPEAT THE $\frac{1}{2}$ TURN CLOCKWISE ROTATION, THEN RESUME THE COUNTER-CLOCKWISE ROTATION WHILE PULLING LATERALLY UNTIL LAG SCREW HAS BEEN REMOVED.